

AVALON
PARK

AVALON
PARK



For more information phone: 613.738.0240 or email: avalon@clvgroup.com



Property Overview

Located just minutes from Elmvale Shopping Centre, Avalon Park is steps away from all of your needs. With OC Transpo bus stops on every corner and easy access to the Queensway, getting around the city has never been easier. Built on beautiful parkland, close to hospitals and surrounded with amenities, Avalon Park is a wonderful place to come home to.

Amenities and Perks

- bachelor, 1 and 2 bedroom suites
- utilities and two appliances included
- 24hr CLV Group emergency service
- fitness facility and sauna
- outdoor swimming pool
- park and children's play area nearby
- party rooms with kitchen facilities
- bicycle storage and locker rooms
- covered and outdoor parking
- laundry facilities on-site
- guest suite



Member of the Ottawa Crime Free Multi-Housing Program
Keeping illegal activity out of rental property



Sample Floor plans



TYPE B2
Bachelor

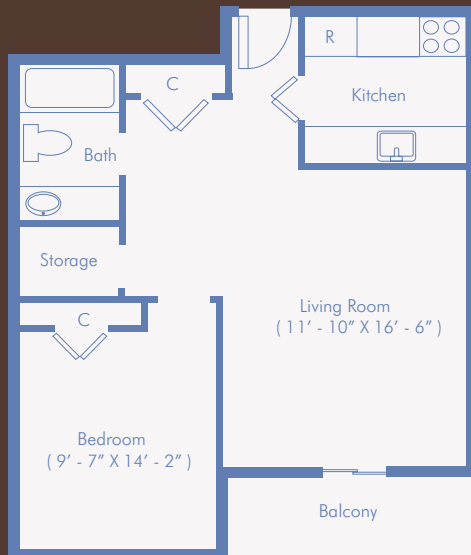

TYPE 1B
1 bedroom

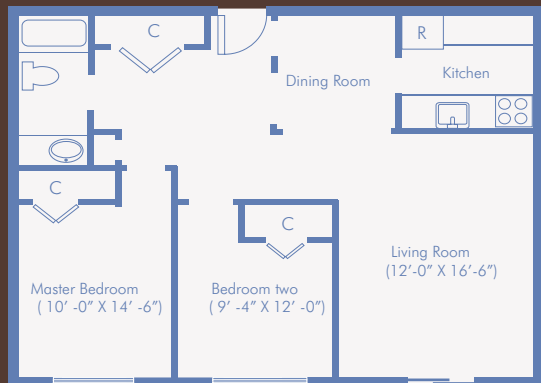

TYPE 2A
2 bedroom



Beautiful
COMMON AREAS



Outdoor
POOL



Guest
SUITE

*Note: Other layouts and sizes also available. Actual measurements may vary slightly. E. & O.E.



Locator Map

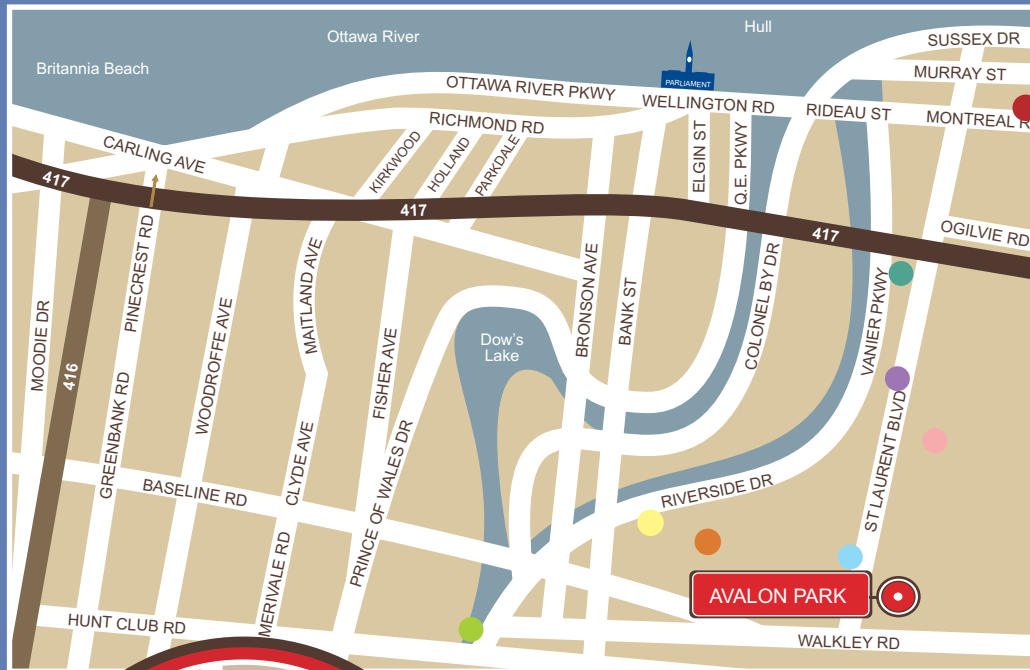

Map not to scale E. & O.E.



- Train Station ●
- Science and Technology Museum ●
- St. Laurent Shopping Centre ●
- Elmvale Shopping Centre ●
- Mooney's Bay Beach and Park ●
- Ottawa General Hospital and CHEO ●
- Riverside Hospital ●
- Montfort Hospital ●



CLV Group is committed to reducing our environmental impact through the use of recycled materials.



**AVALON
PARK**

2470 Southvale Crescent

Rental Office Hours

Mon - Thurs 10am to 6pm
 Fri 10am to 5pm
 Sat 12pm to 4pm

Rental Inquiries:

Phone: 613.738.0240
 Fax: 613.739.7428
 Email: avalon@clvgroup.com

